

Neater Powered Drinker Instruction Manual



Made in the UK by:

Neater Solutions Ltd
12 Burlington Road
Buxton
Derbyshire
SK17 9AL
Tel: +44(0)1298 238823
Email: info@neater.co.uk



December 2020

Description

The **Neater Powered Drinker** has been developed for people who find it difficult to use a conventional cup or straw; or even a conventional Neater Drinker with a non-return valve straw. Users include people with cerebral palsy with impaired lip closure and people with motor neurone disease who have difficulty sucking liquid up a straw.

A remote switch is pressed by the user to pump small measures of liquid up a flexible tube to their mouth. The unit is programmable to ensure the amount of liquid in each cycle is right for the user. It prevents immediate repeat of the pumping cycle ensuring a pause time for the user to swallow. Any device such as this has the potential to cause choking. For this reason, it is only recommended for use by each individual after an assessment by a Speech and Language Therapist.

The Neater Powered Drinker enables people to drink liquids and puréed foods when they want to. It may have benefits other than hydration and nutrition - such as reducing the need for drugs that help expel air from people's stomachs.



Safety

- Read all instructions carefully before use and particularly before making any adjustments. Incorrect use and adjustment could damage the unit and/or make its use dangerous in some way.
- The Neater Powered Drinker should only be used for drinking consumable liquids.
- It should not be used by people with swallowing difficulties or who are liable to choke, except under the supervision of a trained Speech and Language Therapist.
- Liquid pumped into the user's mouth could in some cases enter their lungs without causing a choking reflex. **It is therefore essential that the Neater Powered Drinker is approved for use in each case by a trained Speech and Language Therapist.**
- Drinks should not be scalding hot.
- Clean all parts before use especially the flexible tubing and check that no cracks have appeared in the tubing.
- Take care not to stick the straw in your eye or into the back of your throat.
- The switches supplied should only be used with the unit.
- Neater Powered Drinkers are designed to comply with the essential requirements of the Medical Devices Directive Class 1 (Medical Devices Regulation (EU) 2017/745 of the European Parliament and of the Council of April 2017).

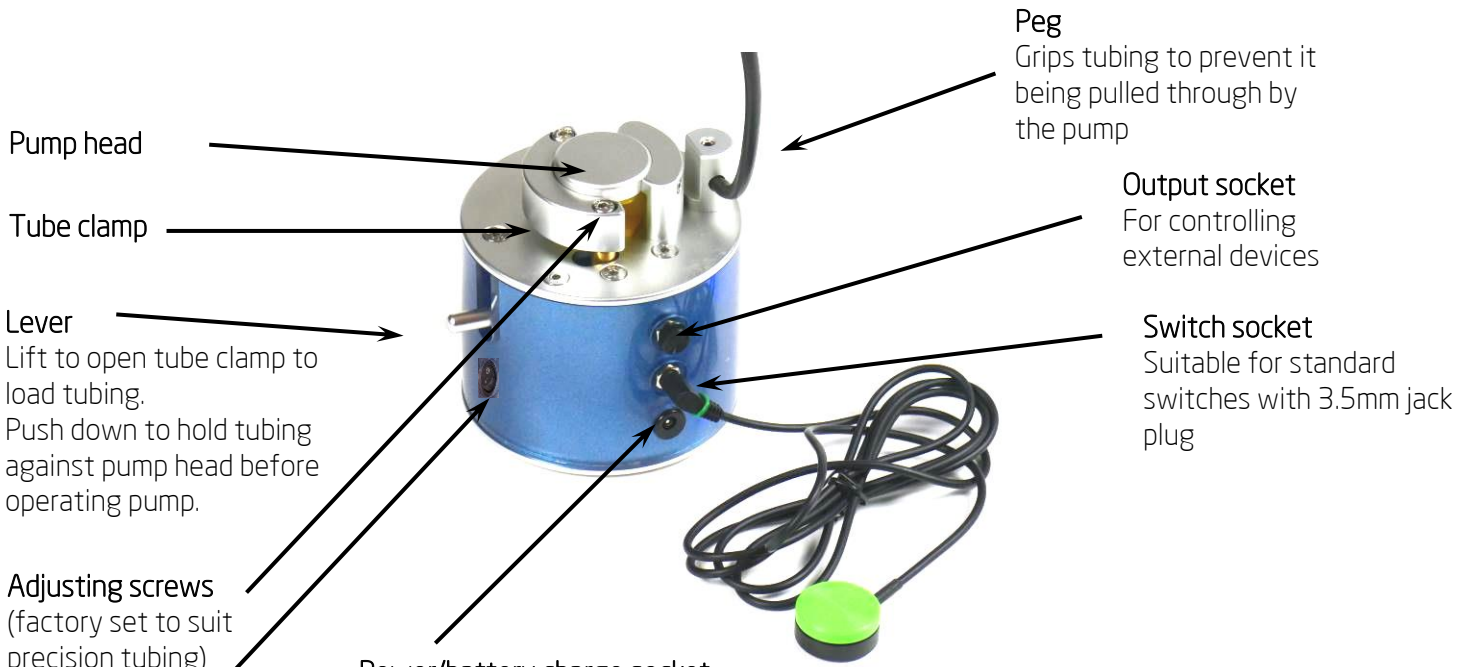

Power/battery charge socket

Only use the 12V DC power supply supplied with the unit.

The display flashes "c" when charging is required.

Charging overnight is recommended though the unit can be used whilst charging.

A **red** LED glows inside when external power is plugged in.

A **green** LED glows inside when the batteries are charging and goes out when fully charged.

If the green LED flashes, a reset is required (battery protection from over-discharge):

Ensure the Battery Switch is On. Then use a pin through the small hole next to the display to briefly press the reset button. Contact your Neater dealer if a new battery pack is required.

Display shows

programme number, pump cycle symbols, priming symbols

C = please charge battery

DISPLAY GOES OUT AFTER A WHILE TO SAVE BATTERY POWER.

To wake up the unit, tap the plug-in switch or switch off and on battery or external power.

Red pump-priming button

To fill tubing with liquid at start:

(ensure display is lit)

1. Push and hold until flashing "P"
2. Let go of the button briefly
3. Push again and hold to prime pump until liquid is near the top of the tube.

You can let go and push again as long as "P" is still flashing (it will time-out after a few seconds)

Black programming buttons

To change programme:

(ensure display is lit)

1. Push and hold top button until "-" appears
2. Select number (higher=longer pumping time) with middle button
3. Push top button to confirm choice

Display	millilitres approx
1	2
2	3
3	4
4	6
5	8
6	11

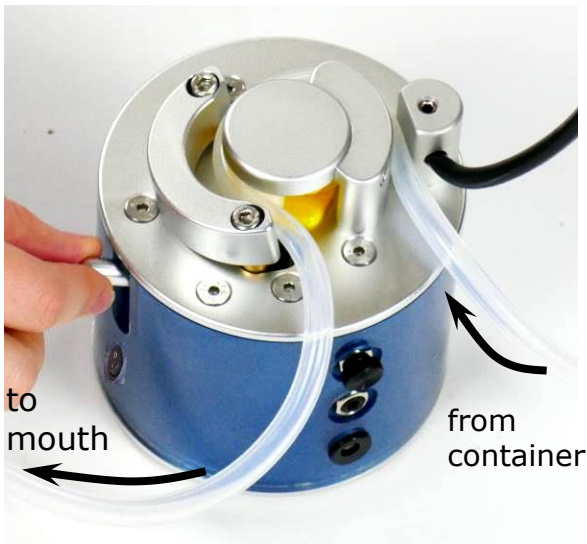

- Load the flexible tubing as shown
- Tuck the tubing (drink container end) behind the peg (stops slipping)
- Push the lever down to clamp the tube
(Only use precision tubing supplied by Neater Solutions – SIL60-4.8x1.6 platinum-cured)



- Ensure tubing sits in the bottom of the container to ensure no air bubbles.
- If the motor runs but liquid is not pumped, try swapping which end of the straw is in the cup and which end is at the user's mouth!

A calibrated container can be used to monitor fluid intake.

Puréed food or thickened drinks of a custard consistency can be pumped.

Water must be pumped through using the unit itself in pump priming mode immediately afterwards to clear the tubing before cleaning.

Take care to avoid spillages into the pump. To remove the straw, lift it out rather than pulling it through the pump.

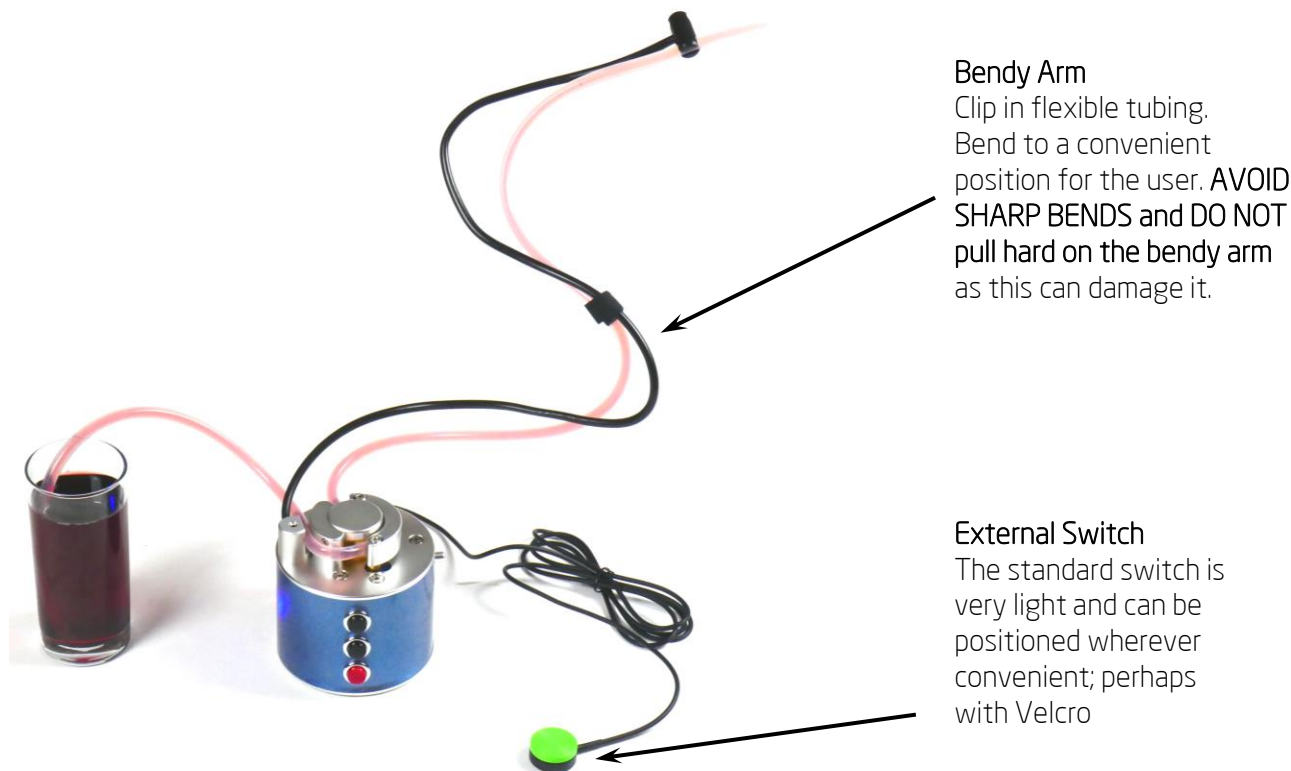

Operation

1. Push and hold the external switch until the unit starts to pump.
 2. The amount of liquid pumped depends upon the programme number selected.
 3. There is then a waiting period during which the unit will not pump again.
- The unit will not pump again if the switch has been held continuously – you have to release and push again.

The programming is designed to minimise the risk of pumping too much liquid at one time. Nevertheless, there is always a risk of choking and **it is strongly recommended that the device should only be used if it has been assessed as safe to use for each individual by a Speech and Language Therapist.**

Cleaning

- Always rinse flexible tubing out and clean before use and immediately after use.
- Use sterilising solution and rinse thoroughly.
- If puréed food or thickened drinks have been pumped, water must be pumped through using the unit itself in pump priming mode immediately afterwards to clear the tubing before cleaning.
- A Tube Cleaning Brush is available (ND-SC)
- Other parts of the unit can be wiped clean; rinsing off any detergent used.
- Some chemicals may attack the plastic casing.
- Do not immerse the unit in water.

Disposal – RoHS and WEEE

This equipment is exempt from the RoHS directive (as medical devices) as long as it is used to assist people with disabilities. Under the WEEE directive it should not be disposed of in the normal waste stream but be placed with separate collection for electrical and electronic equipment (or returned to Neater Solutions Limited). Producer Registration Number: WEE/GB0074UR/PRO



